

INOX

*Pre-rinse Units
and Water Taps*

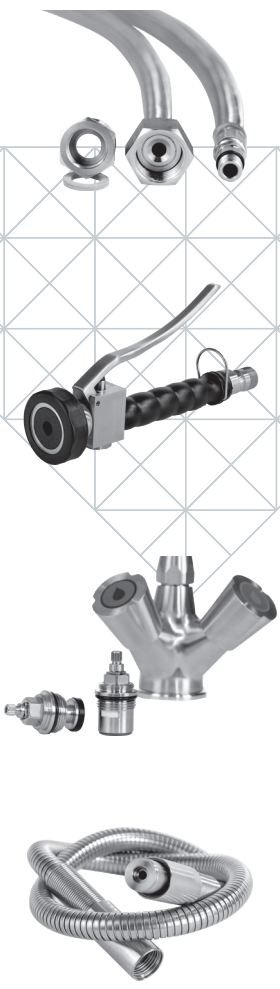

PRE-RINSE UNITS AND COMPONENTS IN STAINLESS STEEL



PRE-RINSE UNITS AND WATER TAPS PRODUCT RANGE **INOX**

- 100% stainless steel
- Stylish design with frosted surface
- In-house assembly followed by strict quality controls



- All components carrying water are made of stainless steel
- With an additional connection adapter for 1/2"÷ 3/8" for easy and smooth installation

PRE-RINSE UNITS AND COMPONENTS IN STAINLESS STEEL



LF Code: 5118026
GEV Code: 549485

STAINLESS STEEL FLEX HOSE 1000 mm ø 1/2"

Stainless steel braided hose with bend protection on both sides (KTW approved) ensures high durability. Best quality on the market



LF Code: 3360029
GEV Code: 546509

STAINLESS STEEL SPRAY GUN ø 1/2" M

Elegant and solid spray gun



LF Code: 3759422
GEV Code: 546069

LUBRICATED VALVE

Robust 3/4" valves for a large flow rate



LF Code: 3759421
GEV Code: 546071

CERAMIC VALVE

Robust 3/4" valves for a large flow rate



- Double o-ring seals for enhanced sealing of the components.
- Spout (ø 25mm) provided additionally with a swivel nut.

PRE-RINSE UNITS WITH MONOBLOC TAP

100% STAINLESS STEEL



LF Code: 5133173
GEV Code: 595009

PRE-RINSE UNITS WITH MONOBLOC TAP

3/4" tap heads allow maximum water flow
Connection adapters in 1/2"÷3/8" are part of the basic equipment

A PRODUCT FOR ALL
SECTORS WHERE THE
HIGHEST STANDARDS
ARE REQUIRED.



LF Code: 3360030
GEV Code: 542574

FLEX HOSE SET STAINLESS STEEL

set including:
Flex hose, 800 mm, 100% stainless steel
Adapter thread 1/2"÷3/8"
Backflow preventer 1/2"

PRE-RINSE UNITS WITH TWO HOLES

100% STAINLESS STEEL



LF Code: 3360028
GEV Code: 595042

PRE-RINSE UNITS WITH TWO HOLES

Top-quality \varnothing 47mm ceramic valve cartridge - Connection 1/2"

OUR STAINLESS STEEL INOX PRODUCTS ARE CHARACTERIZED BY ITS ELEGANT DESIGN AND ROBUST QUALITY.

At REPA, you can get INOX pre-rinse units in all common variants: as monobloc, with twin-holes or for wall mounting.



MORE INOX PRE-RINSE UNITS CAN BE FOUND IN THE REPA WEB SHOPS:

www.gev-online.com
www.lfspareparts724.com



WALL-MOUNTED PRE-RINSE UNITS

100% STAINLESS STEEL



LF Code: 3360032
GEV Code: 595077

WALL-MOUNTED PRE-RINSE UNITS - INOX AUTOMATIC

Water flow is activated by pulling the spray gun
Built-in pressure spring prevents the spray head from springing back and
enables ergonomic working

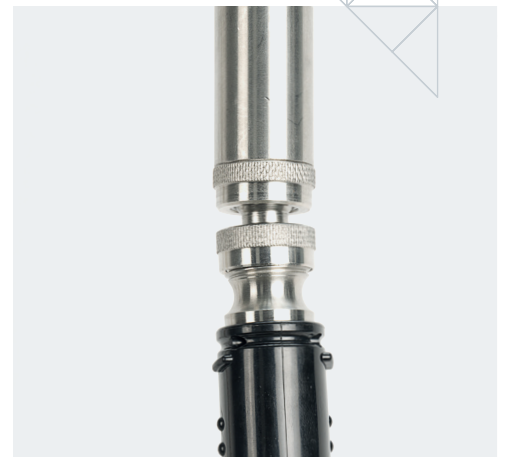
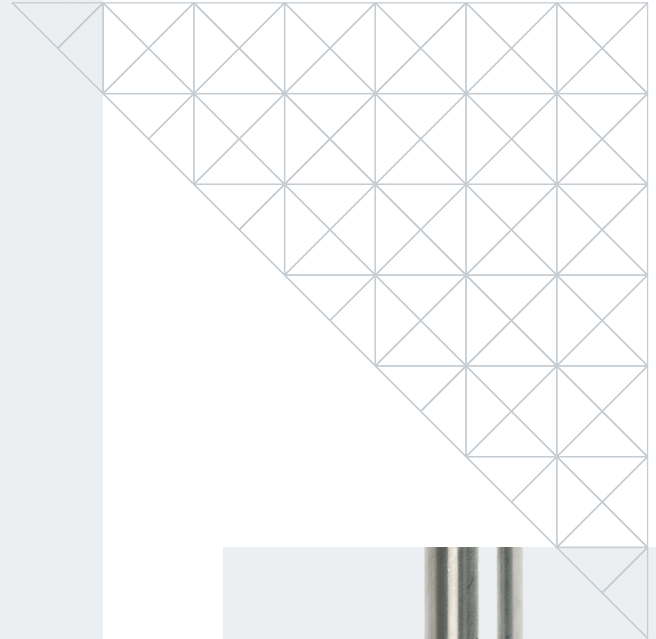

Practical swivel adapter with ball joint for large radius of action

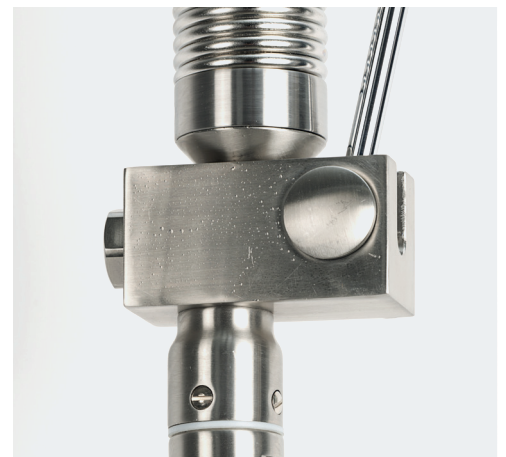

High-quality automatic valve made of stainless steel components

WATER TAPS 3/4"

100% STAINLESS STEEL

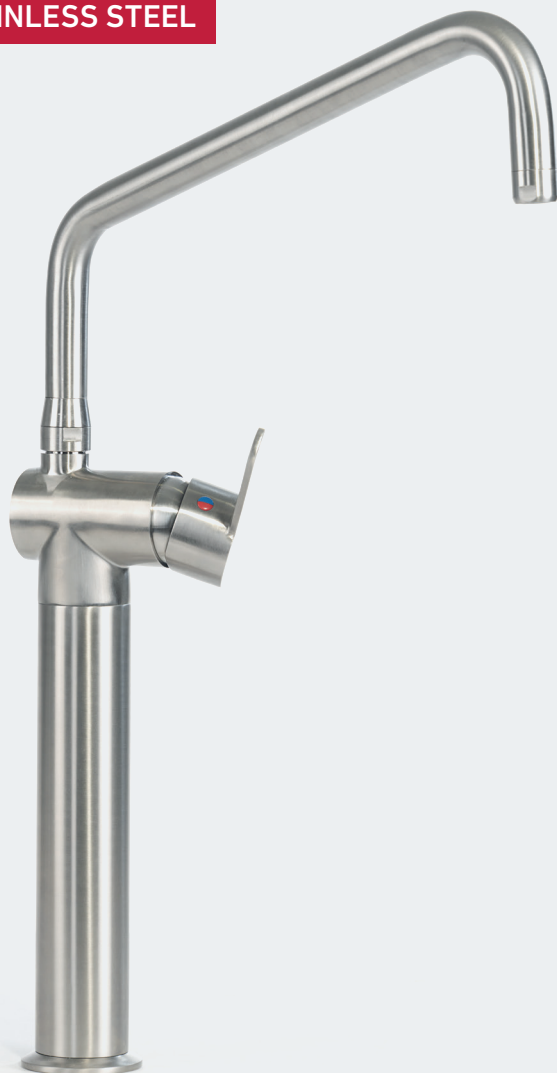

LF Code: 3259047
GEV Code: 595361

INOX PRE-RINSE UNITS AND WATER TAPS:

- Easy cleaning
- Meet the highest hygiene standards
- Long service life even under heavy load

WATER TAPS WITH COLUMN

Column height 260 mm
Spout length 350 mm
With high-quality ø 47 mm
ceramic valve

MORE INOX WATER TAPS CAN BE
FOUND IN THE REPA WEB SHOPS:

www.gev-online.com
www.lfspareparts724.com





GEV Großküchen-Ersatzteil-Vertrieb GmbH

Gadastr. 4
85232 Bergkirchen - Germany
T +49 8142 6522-50
info.ger@repagroup.com
www.gev-online.com

LF S.p.A. a socio unico

Via Voltri 80
47522 Cesena FC - Italy
T +39 0547 341111
info.it@repagroup.com
www.lfspareparts724.com

EPGC S.a.s.

13 Rue des Forts
59960 Neuville en Ferrain - France
T +33 3 20250621
france@repagroup.com
www.epgc.com

Commercial Catering Spares Ltd.

Block C - Axis Point Hill Top Road
Heywood - Lancashire - OL10 2RQ - UK
T +44 1706 621 155
info@ccspares.co.uk
www.ccspares.co.uk

Atel S.r.l. a socio unico

Via Selvuzzis 51/2
33100 Udine UD - Italy
T +39 0432 602095
info@atelitalia.com
www.atelitalia.com

www.repagroup.com

