

Instruction Sheet 238987 for Fitting Encoder Stop Plate Kit 234450K to E30D Series Ovens



SERVICE WORK ONLY TO BE CARRIED OUT BY QUALIFIED PERSONS

Suitable for the following models:

E31D, E32D, E33D and G32D Ovens.

Contents:

Encoder .
 Knob Stop Plate - Turbofan $\pm 30^\circ$.
 Screw M4 x 6 Pan HD Phil NP.
 Knob Turbofan Index

Packed By: -

P.F. 24/11/15
 Initial Date

1. Remove the Temp / Timer control knob from control panel and discard the knob as it is no longer required.
2. Remove the Control Panel from the oven.
3. At the rear of the control panel, disconnect encoder plug from the digital control board.
4. Remove the 2 securing screws securing the encoder to the Control Panel and remove the encoder from the control panel.

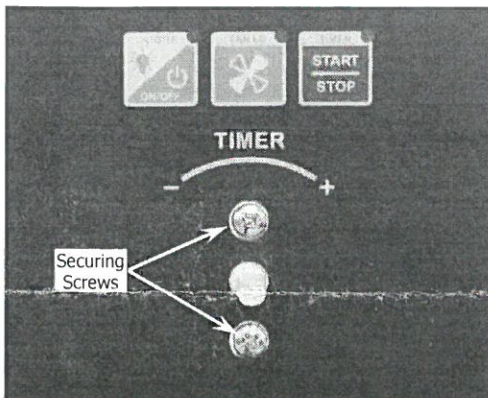

5. Fit replacement encoder and fit the Stop Plate over encoder shaft, ensuring that the stops on the Stop Plate are located on the left side and the encoder shaft flat is facing upwards.
6. Secure the stop plate and the replacement Encoder to the oven using the 2 x M4 Pan HD screws supplied in the kit.

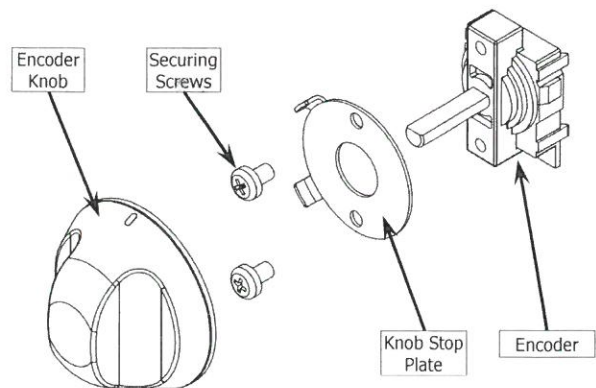
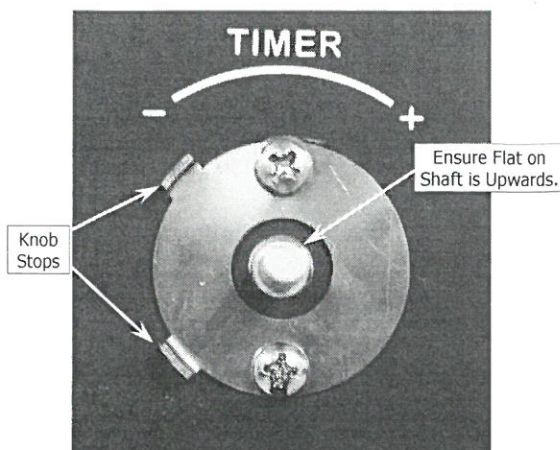

7. Fit the appropriate knob (Timer / Temp Knob) to the Encoder.

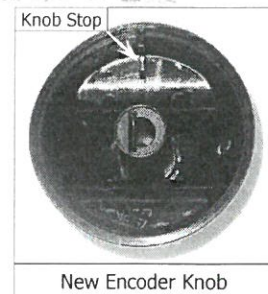
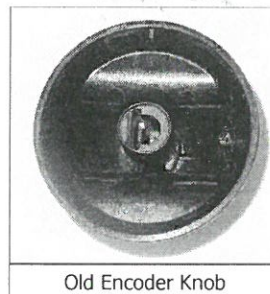

NOTE: New Knob has a 'Stop' on the inside of the knob which will engage between the stops on the Knob Stop Plate.

8. Refit the Control Panel to the oven.