

# ASSISTANCE SHEET

DATE

26/03/2018

## GENERAL INFORMATION

Assistance sheet code	SA84
Title description	Instruction replacement EXPLORA motor



**SAFETY WARNING!** The indications in this service file must be only performed by authorized technical service.  
Any intervention done by non-authorized personal will invalidate the one-year factory warranty.  
Piron is not liable for any damage caused to the equipment or any physical injuries occurring from actions performed not in accordance with the above indications.

**PIRON**<sup>®</sup>  
your professional cooking

# ASSISTANCE SHEET

DATE

26/03/2018

## To do 1:



Disconnect the oven from the power grid.

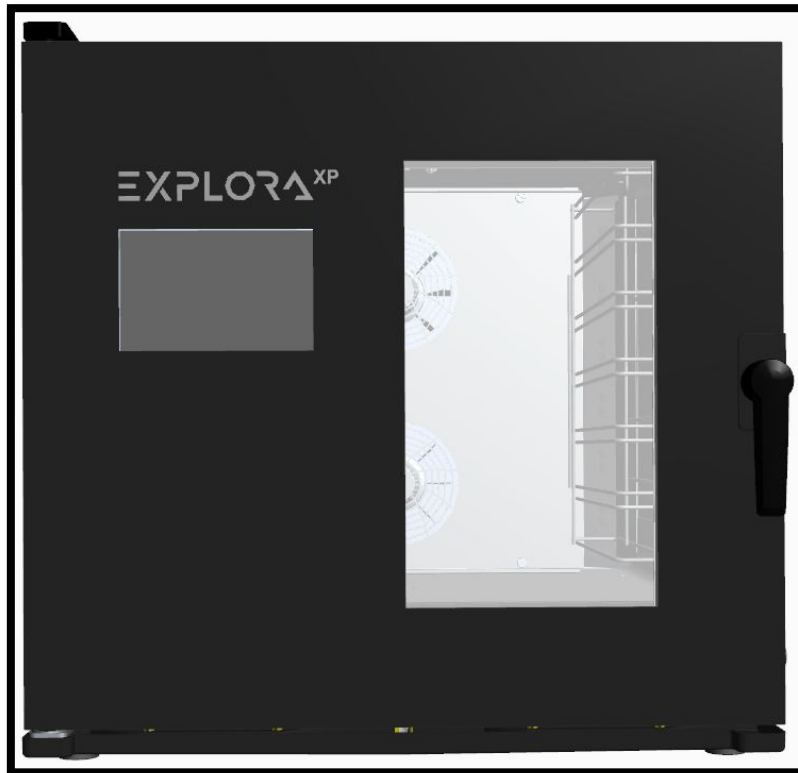

**REMOVE  
THE  
MOTOR'S  
COVER (IN  
RED)  
INSIDE THE  
CAVITY**



# ASSISTANCE SHEET

DATE

26/03/2018

REMOVE  
THE  
IMPELLER  
(IN RED)  
INSIDE THE  
CAVITY



**SAFETY WARNING!** The indications in this service file must be only performed by authorized technical service. Any intervention done by non-authorized personal will invalidate the one-year factory warranty. Piron is not liable for any damage caused to the equipment or any physical injuries occurring from actions performed not in accordance with the above indications.

**PIRON**<sup>®</sup>  
your professional cooking

# ASSISTANCE SHEET

DATE

26/03/2018



REMOVE  
THE BACK  
OF THE  
OVEN



**SAFETY WARNING!** The indications in this service file must be only performed by authorized technical service. Any intervention done by non-authorized personal will invalidate the one-year factory warranty. Piron is not liable for any damage caused to the equipment or any physical injuries occurring from actions performed not in accordance with the above indications.

**PIRON**<sup>®</sup>  
your professional cooking

# ASSISTANCE SHEET

DATE

26/03/2018

UNSCREW THE  
SENSOR  
MOTOR'S  
,UNSCREWS  
THE 4 SCREWS  
AND PULL OUT  
THE MOTOR .  
CHANGE IT  
AND FIX THE  
SENSOR ON  
THE NEW  
MOTOR.FIX  
THE MOTOR.

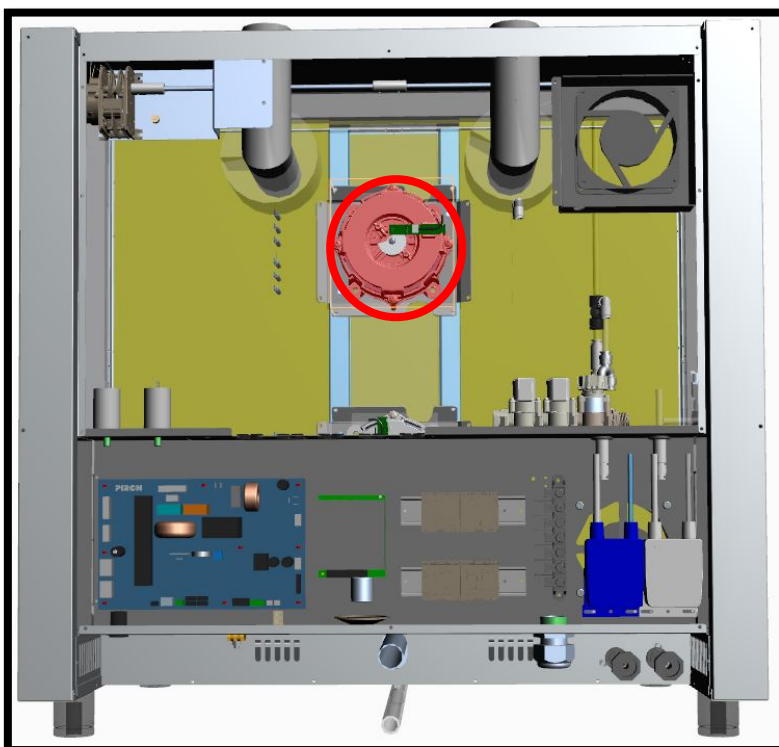

Reconnect the oven to the power grid