

# automatic water softener GIX5



AUTOTROL 255 / 740 LOGIX VALVE

## WATER NETWORK CONNECTIONS

CONNECTION 3/4" G

CONNECTION 1/2" G

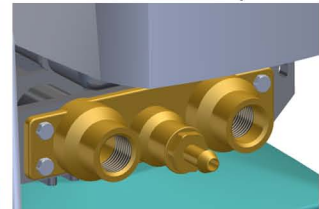
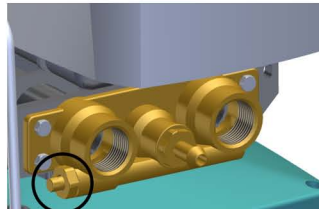

MIXER

### TECHNICAL DATA

Width	230 mm
Height	515 mm
Depth	385 mm
Weight	11 Kg
Power supply	230V 50/60 Hz standard 120V 60 Hz optional
Maximum flow rate	1500 l/h
Room temperature	4°-30°C
Power requirement	4 W
Water network connections:	3/4" G with mixer ; 1/2" G;
Regeneration salt amount:	0.6 kg
Maximum salt content in the brine tank:	10 kg

### SUPPLY WATER CHARACTERISTICS

Drinking water  
 Temperature: min 4°C-max 25°C  
 Pressure: min 2 bar, max 8 bar  
 Crystal-clear water (SDI 1)  
 Maximum hardness: 90 °f

### 1 WATER SOFTENER CONSISTING OF:

- 1 brine tank
- 1 Autotrol 255/740 Logix valve
- 1 cylinder holding 3.5 litres of cationic resins adapt for softening
- 1 instruction manual
- 4 m of unloading pipe
- 1 overflow curved union joint
- 1 fitting for the unloading pipe
- 1 chlorine generator (OPTIONAL)

### THE WATER SOFTENER IS SUITED FOR:

- coffee machines and glasswashers
- glasswashers
- dishwashers
- convection ovens
- ice makers

### PRODUCT CODE:

- ACX02 with connections 1/2" G
- ACX05 with connections 3/4" G mixer

### Litres of softened water according to its hardness

WATER HARDNESS	20°f 11°d 200 ppm CaCO <sub>3</sub>	30°f 16°d 300 ppm CaCO <sub>3</sub>	40°f 22°d 400 ppm CaCO <sub>3</sub>	50°f 28°d 500 ppm CaCO <sub>3</sub>	60°f 33°d 600 ppm CaCO <sub>3</sub>
softened litres	1050	700	525	420	350

cycle capacity : 21 m<sup>3</sup> °f